

## Vintage Chorus

Thank you for purchasing this nux CH2 Vintage Chorus. Please read this manual carefully before using the device.

### 1.Features

- Very high quality effect with flexible function.
- Adapted low noise BBD in delay circuit, natural and clear sound.
- FET electronic switching provides clickless, popfree switching.
- Top loading battery can be changed without tools.
- LED indicator shows status of effect and battery condition.
- The pedal can be powered by a battery or an optional AC adaptor.

### 2.OPERATION DESCRIPTIONS

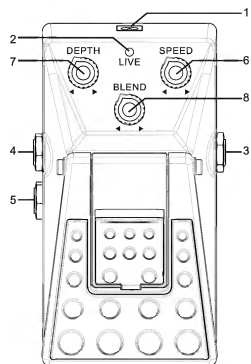

1. AC Adaptor Jack (An AC/DC adaptor is a device of 9V by which the output was stabilized, and please use the type of negative tip.)
2. LED Indicator: Lights up when the pedal is enabled.
3. INPUT Jack: Connect the INPUT of the pedal to your guitar or some other effects unit with a 1/4-inch mono phone plug.
4. OUT A Jack: Connect the effect sound of the pedal to your guitar amplifier or the Input of the other effects unit.
5. OUT B Jack: Connect dry signal of the pedal to another amplifier or input of the other effects unit.
6. SPEED: Varies sweep rate.
7. DEPTH: Control the amount of sweep deviation.
8. BLEND: Control the amount of chorus effect signal.

### 3.CHANGING BATTERY

When the indicator light goes dim or no longer lights while an effect is on, or when you hear that the sound has some level loss and distortion, it means that the battery must be replaced.

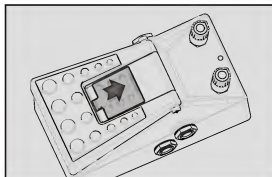

1. Pull the battery compartment lid and lift up.

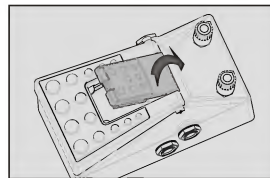

2. Replace the battery.  
Be sure to carefully observe the battery polarity.

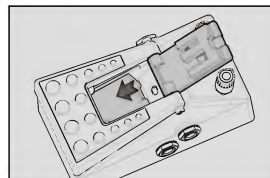

3. Put the battery compartment lid into the groove and push into end.

### NOTES

1. Unplug the instrument when it is not in use for a longer battery life.
2. If storing the unit for a long period, remove the battery, which would prevent possible damage from battery leaking.
3. Be sure to use the appropriate AC adaptor (9V negative tip).

### 4.SPECIFICATIONS

Input Impedance: 1M Ohms

Output Impedance: 10k Ohms

Power Supply: One 9V battery or external AC adaptor (9V)

## 合唱效果器

感谢您选择使用NUX CH2合唱效果器。  
在使用本产品之前请仔细阅读本说明书。

### 1. 产品特性

- 以灵便的操作方式产生高质的失真效果。
- 由低噪音BBD延时电路获得自然纯净的声音。
- 采用电子场管控制方式的无杂音开关踏板。
- 可在顶部方便装载电池,无需另外的附加工具。
- 可指示效果器工作状态以及电量的指示灯。
- 可选择电池或者可选的交流适配器供电。

### 2. 操作说明书

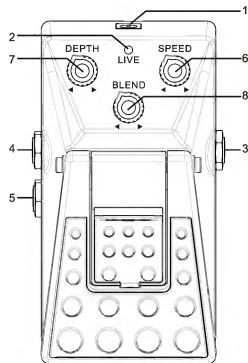

1. 交流适配器插口（即交流转稳定直流的9伏适配器，需内正外负型。）
2. LED指示灯：效果器校音使用时亮。
3. 输入插口(INPUT)：用6.3mm型号的音频插头使效果器的输入与电子吉他或者其他的效果器建立连接。
4. 输出插口A(OUT A)：用6.3mm型号的音频插头使效果器的效果输出与吉他音响或者其他的效果器建立连接。
5. 输出插口B(OUT B)：用6.3mm型号的音频插头使效果器的未加效果输出与吉他音响或者其他的效果器建立连接。
6. 速度（SPEED）：调节信号波形变化速度。
7. 深度（DEPTH）：调节信号波形的偏量。
8. 混合（BLEND）：调节输出信号合唱效果的程度。

### 3. 电池更换

当指示灯出现亮度变暗，在效果状态不亮，或者声音变弱、失真时，请更换电池。

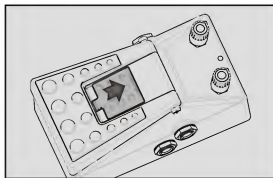

1. 如图，拉开电池仓门，打开电池盖

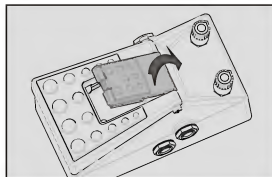

2. 更换电池，请注意电池的极性。

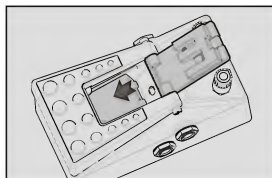

3. 关好电池盖，推进电池仓门。

### 注意事项

1. 为了延长电池使用寿命，请在不使用设备时，拔出设备连接头。
2. 若要长期放置产品，请把电池拿出，防止电池漏电对产品造成损坏。
3. 必须使用相适应的交流电源适配器（9V，内负外正）

### 4. 规格参数

输入阻抗: 1兆欧

输出阻抗: 10千欧

工作电压: 1颗9V电池或者外接9V交流电源适配器。